

## The Sea Breeze

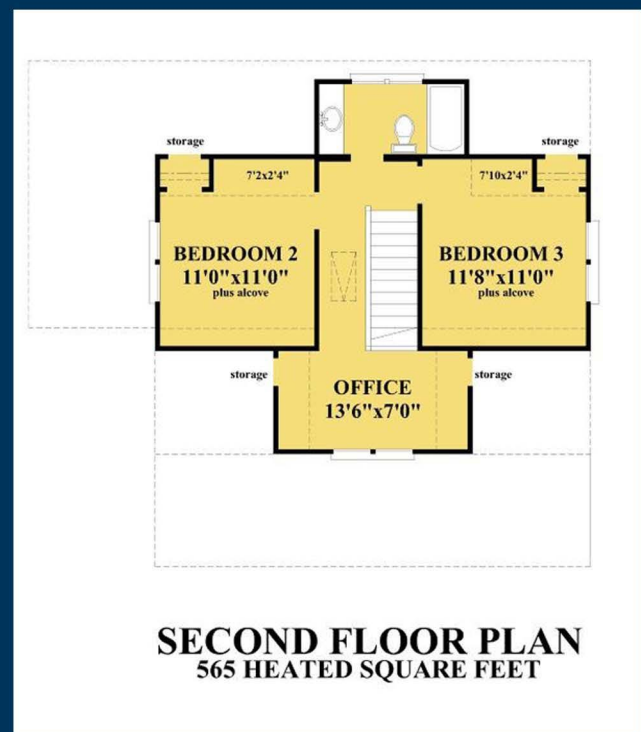

This house plan offers an open floor plan, kitchen with large walk-in pantry and nice sized owner's suite all in a smaller footprint. The second floor features two bedrooms and two areas for walk-in attic space.



**House Plan Specifications 1,914 SQ FT**

**Foot Print 45'-0"x61'-4" w/o stairs**

**Stories 2**

**Bedrooms 3**

**Bathrooms 2.5**

**First Floor Ceiling Height 9'**

**Second Floor Ceiling Height 9'**

**House Width 45' 0"**

**House Depth 61' 4"**

**Foundation Crawl Space**

**Garage Front Load**



*Let me help you build a new home!*



Monument  
Sotheby's  
INTERNATIONAL REALTY



**Robert Smith Jr**

Vice President  
Monument Sotheby's International Realty

Cell 443.956.3588  
Office 410.525.5435  
robert.smith@sothebysrealty.com

*Serving all of your real estate needs*